



Issue 5.

////

OrmeauBathsGallery

Autumn/Winter Schedule

September 2010—

April 2011

////

Cover/
detail from
'The Bayonn'
'A Certain Distance'
Endless Light'
mine, Writeshough
Institute of Modern
Art, 2010

Calendar

/////

OrmeauBathsGallery
Issue 5/2010
Autumn Winter Schedule
September 2010—
April 2011

/////

Siobhán Hapaska///// 4

Friday September 24 – Saturday November 6

Downfall

Siobhán Hapaska was born in Belfast in 1963 and has exhibited in major exhibitions internationally. This is the first major exhibition of her work in her native city and will include a combination of new and recent works.

William Mc Keown///// 6

Five Working Days

November 19 2010 – Jan 15 2011

William McKeown will create five installations that use the Ormeau Baths galleries as metaphorical spaces for daily existence.

Philp Napier///// 8

Croupage

February 4 – March 19

Ormeau Baths Gallery presents a major solo exhibition of selected projects from one of the most influential and pioneering sculptors of his generation.

Act In Progress – Children’s Exhibition ///// 10

March 29 – April 2 2011

Ormeau Baths Gallery is delighted to present this exhibition which showcases the results of three children’s projects with which OBG has engaged during the year.



Following a very successful Spring/Summer programme OBG once again brings an excellent programme of important contemporary visual art throughout Autumn/Winter 2010/11. We are thrilled to show three solo exhibitions by internationally renowned artists; Siobhan Hapaska, William McKeown and Philip Napier.

These exhibitions reflect the continued growth of OBG as Northern Ireland’s leading contemporary visual art space. As always we are indebted to our funders, most notably the Arts Council of Northern Ireland. We are also grateful to Belfast City Council for their continued support and that of our sponsors and donors; all of which make it possible to bring important visual art to our visitors. Our funders together with our staff and volunteers, enable the delivery of this exciting programme; my thanks to them all.

Our visitor numbers have continued to grow due, in no small measure, to the calibre of exhibitions and also due to the associated Education and Community Programme.

I hope you enjoy reading through our brochure where you will find details on all exhibitions through to March 2010 together with a wide range of events. More importantly I hope you will join us at the Gallery and enjoy this excellent programme in person.

Martin Bradley
Chair



Above
Downfall 2009

Downfall

Friday February 4
- Saturday March

Siobhán Hapaska

Siobhan Hapaska was born in Belfast in 1963. She is a graduate of Goldsmith's College, London (1992) and has consistently exhibited in major exhibitions internationally including Documenta X, Germany; Venice Biennale 2001 and Magasin 3, Stockholm. This is the first major exhibition of her work in her native city and will include a combination of new and recent works.

Her art practice is multilayered and feelings of uncertainty, restlessness and change have marked her work and certain binary conditions such as nature and artifice; presence and absence; life and death have preoccupied the artist in the past. This exhibition, inter alia, will engage with the lingering theme of dislocation and loss of instinct as explored in recent works.

She has said of her practice - 'Uncertainty in my work is very important to me. I'm really not interested in definitive explanations of things - I find certainty so claustrophobic'.

As will be seen Siobhan Hapaska's work depth charges a number of cultural and socio-political issues and this Belfast exhibition will open up for assessment the extent to which biography/identity have been underpinning its development.

The exhibition is curated by Liam Kelly.



Above & Opposite
Downfall 2009
olive tree, slate,
powder in resin,
fbre glass, soil, steel,
cable, rigging components,
265x121x410cm,
copyright Sichhan Hapaska,
courtesy Kerlin Gallery





Education

Siobhán Hapaska Events

*Caoimhín Mac Giolla Léith
on Siobhán Hapaska
Thursday 30th September
7pm/Free*

Caoimhín Mac Giolla Léith will discuss Hapaska's new work at OBG. Mac Giolla Léith is a critic, curator, author and Senior Lecturer at University College Dublin. He was a judge for the Turner Prize 2005 and contributes regularly to major art publications.

*Written Responses
Saturday 9th October
2pm/Free*

Poet and critic Miriam Gamble hosts this creative writing workshop which aims to expand the visitor's experience of Hapaska's work. Participants will draw upon the extraordinary physical structures of Hapaska's sculptures and the ideas they evoke to inspire new writing. Suitable for those interested in creative writing, art criticism and for anyone who would like to view the work from a different perspective.

Miriam Gamble was born in Brussels, but grew up in Belfast. Her first collection of poems, *The Squirrels are Dead*, was published by Bloodaxe Books earlier this year; her work also features in the Bloodaxe anthology *Voice Recognition: 21 Poets for the 21st Century*. Miriam won an Eric Gregory Award in 2007, and she is the 2010 recipient of the Ireland Chair of Poetry Bursary Award. She lives in Glasgow.

*Belfast Sculpture Journey
Saturday 6th November
2pm/Free*

Artist Sinéad Bhreathnach-Cashell hosts this workshop which invites participants on an unusual sculptural journey around Belfast, the birthplace of Siobhán Hapaska. Participants are invited to use objects and ideas from the everyday to create sculptural interventions around the city. The tour begins at OBG and ends at PLACE in Belfast. This event is suitable for all ages.

*Artist Choice Screening at QFT
30th October
3pm*

Film is a continuous source of interest to Siobhán Hapaska. For this exhibition the artist has selected a film which has informed and inspired her work which will be screened at QFT. Hapaska will introduce the screening.



place



'Whitby'
Kerlin Gallery,
Dublin, 2010

Five Working Days

November 19
2010—Jan 15 2011

William McKeown

The Ormeau Baths Gallery presents a major solo exhibition by Northern Irish artist William McKeown entitled 'Five Working Days'. William McKeown (b.1962) is highly regarded for his paintings, drawings, watercolours and constructions/installations that express his concern about our ongoing relationship with nature both outside and within. He is interested in the sky around us; the air that we exist in and our daily emergence into light. His work is poetic, expansive and captures the essence of a time and a place. It is centred around issues of beauty, happiness, acceptance and freedom.

For this new show, William McKeown will create five installations that use the Ormeau Baths galleries as metaphorical spaces for daily existence.

McKeown earlier this year made two, two person shows; 'Pool' with Irish/International artist Dorothy Cross at the Kerlin Gallery, Dublin and 'A Certain Distance, Endless Light' with works by American artist Felix Gonzalez-Torres at mima, Middlesbrough Institute of Modern Art. William McKeown had a major solo exhibition at IMMA, the Irish Museum of Modern Art in 2008/09.



Education

William McKeown Events

In Conversation

Thursday 25th November

7pm/ Free

William McKeown talks to critic, curator, writer and lecturer Declan Long about the work on display at OBG.

A certain distance, endless light:

A talk about painting

by Gavin Delahunty

Thursday 9th December

7pm/ Free

A talk by Gavin Delahunty which will place McKeown's work in a broader context of contemporary painting, exploring key themes, trends and some of the most significant painters working today.

Delahunty is currently Curator at mima (Middlesbrough Institute of Modern Art). At mima, he has curated a number of important shows including *British Surrealism & Other Realities*, *A Certain Distance Endless Light: A project by Felix Gonzalez-Torres & William McKeown*, *The End of the Line: Attitudes in Drawing*. He is currently working towards the opening of Gerhard Richter: *Lines which do not exist*, will open at The Drawing Center, New York in September 2010.

Sleeping & Waking Minds:

The Biomuse Trio

Saturday 15th January

2pm/ Free

This workshop expands on the capacity for art, and specifically McKeown's work to investigate and evoke states of mind. This workshop will explore techniques and concepts behind a piece of music that is currently being made by a group of artists known as the Biomuse Trio.

The composition is 'Music for Sleeping & Waking Minds,' a work that proposes a novel idea: that art can emerge as a process of evolving, collective consciousness. In the piece, performers are connected to electroencephalogram (EEG) monitors. During the course of this composition the performers rest, sleep and gradually awaken. As they move between different states of consciousness (and cycle between the different stages of sleep) their brainwaves drive the generation of music, which changes according to shifts in brainwave activity.

Experiment with Painting

Wednesday 15th December

6pm/ £5

Escape the Christmas frenzy with this informal painting class taught by artist Susan Hughes. This class will explore some of the themes behind McKeown's work. This class is suitable for people of all abilities.





Art in Progress Children's Exhibition

March 29
- April 2

Art in Progress

Ormeau Baths Gallery is delighted to present this exhibition which showcases the results of three children's projects in which OBG has engaged during the year. This is an exciting celebration of the artwork of children which incorporates a wide range of themes using a diverse range of materials. This exhibition will be open to the public from Tuesday 29th March – Saturday 2nd April.

Artist in Residency

Now in its third year this programme was set up to introduce contemporary art into the classroom; especially for schools with little access to art facilities. Working closely with the teacher and class over the course of a term, our selected artists brings to life aspects of the curriculum.

Great Art Quest

Ormeau Baths Gallery has been selected as one of four major art centres in the UK to take part in the 'Great Art Quest', through the Princes Foundation for Children and the Arts. This scheme is designed to introduce primary school children to visual art in a gallery setting.

Saturday Art Club

An opportunity to see the best work produced in our Saturday Art Club during the season. The standard of work always amazes us and we want to share it with our visitors.



Groupage

February 4
– March 19

Philip Napier

Ormeau Baths Gallery presents a major solo exhibition of the work of the internationally acclaimed artist Philip Napier and one of the most influential and pioneering sculptors of his generation.

This exhibition explores themes that have engaged Napier over the last two decades.

The work included in this exhibition has been made relating to environments of 'emergency provisions' through negotiated political transformation to our post conflict conditions of conspicuous consumption – a problematic reconstruction of civil recovery, renegotiating the demilitarised state.

The international dimensions in selected projects suggest the Northern Irish context as being a theatre focussing larger expanded issues of authority, control and sovereignty which are in transition.



Image
Neil Bevison photography,
from Lyric Studio and
OBG presentation 'Lives of
Spaces' November 2010



Education

Philip Napier Events

In Conversation

Thursday 10th February

7pm/ Free

Artist Philip Napier and Declan McGonagle (Director of NCAD, writer, and former Director of IMMA) will discuss the current exhibition at OBG.

The Work of Philip Napier

Thursday 24th February

7pm/ Free

This talk provides an overview of Napier's work by Professor Liam Kelly.

OBG Guest Lecture

Wednesday 2nd March

7pm/ Free

OBG has commissioned a talk by Broadcaster and Journalist William Crawley to research and explore the themes driving Napier's most recent body of work including historical and contemporary global trade routes and the changing hierarchies, and political nature of trade. This talk will provide crucial context to the issues that are being dealt with in the exhibition.

A Small Adventure with Philip Napier

Sunday 20th February

8pm/ Free

As part of a set of workshops that explore and devise, members of the Lyric Theatre's Drama Studio (the theatre's professional training programme for 18 to 25 year olds) will once again spend two days creating work in OBG in response to the exhibition, culminating in a short informal performance.

OBG and VAI Critical Writing Competition 2011

OBG is pleased to announce a new critical writing competition in partnership with Visual Artists Ireland which aims to encourage, support and promote critical discussion on the Visual Arts in Northern Ireland.

The competition is open to all emerging critics and is based around 'Groupage' the exhibition by Philip Napier which is showing at OBG from 4th February – 19th March 2011.

To enter please submit a 1000 word discursive text on 'Groupage' with reference to the processes and thinking behind the making of the work. Please enter this text along with your name, contact telephone number, email and postal address. This can be emailed to chickey@ormeaubaths.co.uk or posted to Ormeau Baths Gallery, 18a Ormeau Avenue, Belfast, BT2 8HS. The deadline is 4pm on 11th March 2011. There is a prize of £300 and the winning entry will be published in the April edition of the Visual Artists Newsletter and on the new OBG website. The winning piece will be selected by a panel of judges including Jason Oakley, Editor of Visual Artists Newsletter, the newly appointed Artistic Director of OBG and an art critic TBC. To accompany this competition OBG is hosting a series of Critical talks and Q&A sessions with prominent art critics.

Please see www.ormeaubaths.co.uk for more details.



Education and Community at OBG

Education is an important part of the activities that take place at OBG. We are committed to providing imaginative ways to promote the enjoyment, engagement and understanding of contemporary art. For every exhibition that takes place at OBG we host a dynamic range of thematic events tailored to each show.

OBG Schools programme

School groups are always warmly welcomed at OBG. We encourage students to look closely at and discuss works of art. Tours and workshops are designed to generate critical thinking.

Contact us to arrange a free tour or workshop for your class.

Community Programme

OBG runs an ongoing series of community projects, building relationships with local communities as well as a diverse range of groups around Northern Ireland. We organise workshops, short and long term project work and are currently involved in projects with the Simon Community, RNIB, Mencap and local community centres. If you have a group that wants to engage with art get in touch, we want to work with you!



Saturday Art Club at OBG

OBG Saturday Art Club continues over autumn and winter 2010/2011.

These workshops are designed by professional artists to match the themes of each exhibition and use a wide range of techniques and media. Workshops cost £3 per child and take place 10.30am – 12.30pm.

Siobhan Hapaska

2nd October – 6 – 8 year olds
9th October – 8 – 10 year olds
16th October – 10 – 13 year olds
23rd October – Family Workshop

William McKeown

27th November – 6 – 8 year olds
4th December – 8 – 10 year olds
11th December – 10 – 13 year olds
8th January – Family Workshop

Philip Napier

12th February – 6 – 8 year olds
19th February – 8 – 10 year olds
26th February – 10 – 13 year olds
5th March – Family Workshop



Image
Jack Doherty

Volunteers & Staff

OBG is presently looking for volunteers.

For volunteer enquiries contact Gillian Collins on 028 9032 1402 or email info@ocmeaubaths.co.uk

Board

Martin Bradley (Chair)
Eileen Mullan (Secretary)
Angela Connolly
Prof. Liam Kelly
David Gould
Paul Mullan (Treasurer)
Rosie Ford Hutchinson
Richard Conway

Staff

Glenny Whitley (Gallery Manager)
Feargal O'Malley (Exhibition Manager)
Ciara Hickey (Education and Community Officer)
Michael Monan (Events and Services Officer)
Gillian Collins (Gallery Administrator/Press Assistant)

Volunteers

Susan Stewart
Angus Sutherland
Sarah Majury
Christopher McKinney
Seana Kane
Maeve Henry
Becky Piggot
Ruth Crowther
Ben Newell
Paula Sheppard

Sponsorship

Donating to OBG helps us to continue to:

Present landmark exhibitions, develop our Education and Community projects, promote the visual arts and support cultural tourism in Northern Ireland. Provide a free visual arts resource for the communities of Northern Ireland.

All donations make a difference.

Postal donations can be made payable to **Ormeau Avenue Gallery 18a Ormeau Avenue Belfast BT2 8HS**



Image
Jack Doherty

FUNDERS

PRIMARY – ARTS COUNCIL OF NORTHERN IRELAND / www.artsCouncil-ni.org

SECONDARY – BELFAST CITY COUNCIL / www.belfastcity.gov.uk



EXHIBITION PARTNERS

POTATO BRED INSTALLATION SPECIALIST / www.potatobred.com

THIRD SOURCE/AUDIO VISUAL SPECIALIST / www.thirdsource.co.uk



As the foremost and largest art space in Northern Ireland, OBG attracts exhibitions by artists working at the highest level of international contemporary Art, Design, Fashion, Craft and Architecture.

Our Exhibition Programme and Education and Community projects encourage and foster innovation and creativity.

Supporting the work of Ormeau Baths Gallery can offer a perfect opportunity for your company to achieve its own corporate objectives through positioning your brand as a supporter of an established cutting edge international contemporary visual arts venue.

Sponsorship of OBG offers you a host of rewarding benefits including

- Aligning themselves with the leading visual arts organisation in the region
- Sponsorship of cutting edge contemporary visual arts exhibitions
- Sponsorship of our imaginative Education and Community projects
- The opportunity to involve your staff and associates with the gallery and exhibition activity including exhibition launches and private viewings
- Branding opportunities within the venue and on OBG marketing material.

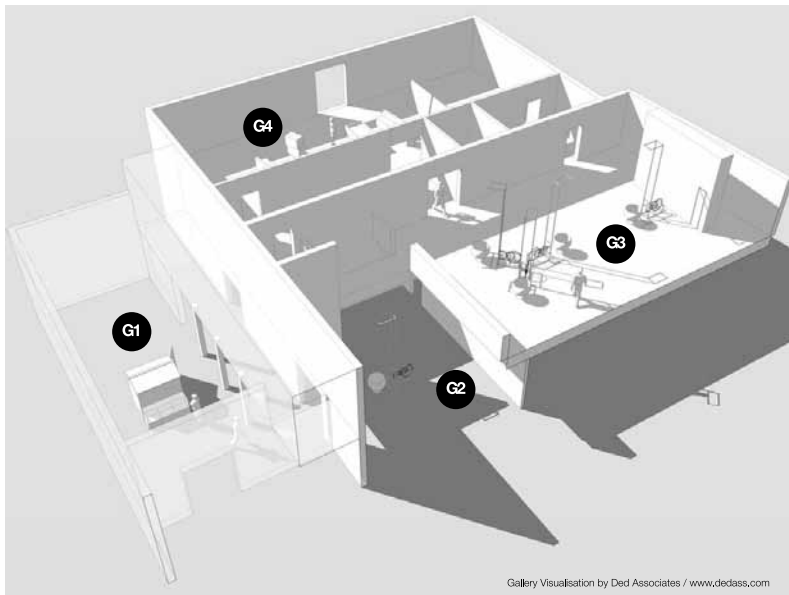

G1—Gallery 1 / G2—Gallery 2 / G3—Gallery 3 / G4—Gallery 4

Gallery Visualisation by Ded Associates / www.dedass.com

All events, dates and information within this programme to our knowledge are correct at time of going to press and OBG accept no responsibility for any errors or misrepresentation.

Opening Hours
Tuesday–Saturday
10am–5:30pm
Last admission 5:00pm

Free Mailing List
If you would like to join our free mailing list please complete the form available at reception, or contact the administrator.

Visitors access
OBG welcomes visitors with disability. Wheelchair access is not possible through our main entrance on Ormeau Avenue. However, wheelchair access is possible via the Apsley Street entrance. Once inside the gallery all floors are completely accessible. OBG also has disabled toilet facilities.

Location
OBG is located in Ormeau Avenue, just off the Dublin Road and Bedford Street, 100 yards from the BBC.

We are 10 minutes walk from Victoria Station, Europa Bus Depot and Central Station. Ample meter and public parking is available in the area.

Admission to the gallery is free.



/////

OrmeauBathsGallery
Issue 5/2010/11
Autumn Winter Schedule
September 2010—
April 2011
/////

ORMEAU BATHS GALLERY
18A ORMEAU AVENUE
BELFAST
BT2 8HS

TELEPHONE

+44 (0)28 9032 1402

FACSIMILE

+44 (0)28 9031 2232

MAIL@ORMEAUBATHS.CO.UK

WWW.ORMEAUBATHS.CO.UK